



HONGYAO Lighting

Specification Sheet

- LED DISK LIGHT -
(3 CCT Tunable)



Zhejiang Hongyao Lighting Electrical Co., Ltd

No.209 Shennan Rd. Da Yang Jie Dao, Linhai City. Zhejiang China 317000 www.chhongyao.com
Trading@chhongyao.com Tel: +86 576-85381918 Fax: +86 576-85381913

SPECIFICATIONS

FEATURE

- Featuring tunable White Color Temperature: 3000K, 4000K and 5000K
- Body: cold rolled steel, with a phosphate bonding process and post-painted with high temperature-baked white enamel for superior quality
- Diffusers: High light transmittance polycarbonate
- The LED fixture is Triac dimming
- High luminous efficiency, good color
- WARRANTY--5-year limited warranty



APPLICATION

- drawing room, bedroom, corridor and administration office

SPECIFICATIONS

Model No.	HY-DSL-R4-10W-3CCT	HY-DSL-R6-15W-3CCT
Power:	10W	15W
Size:	4"	6"
Input Voltage:	120 VAC	
Lumens	800LM	1200LM
Dimming	Triac dimming	
Protection Rating	IP20 (For Indoor Use Only)	
Beam Angle	120°	
CCT:	3CCT Tunable (3000K/4000K/5000K)	
CRI:	>80	
Working Life:	Lumen Maintenance over 70% @ 50,000+ Hours	
Oper. Temperature	-13°F ~+113°F / -25°C ~+45°C	
Certification	ETL	

PRODUCT DIMENSIONS

Front View

Side View

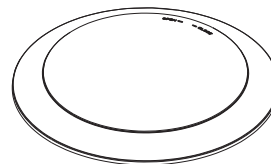
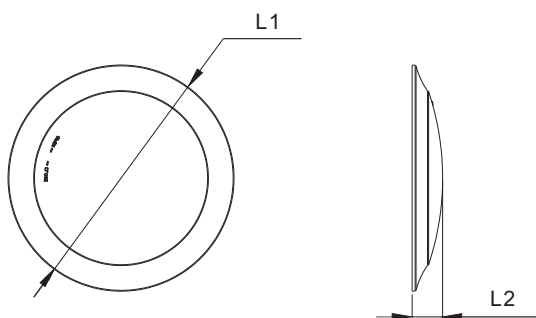

Model No.	HY -DSL-R4-10W-3CCT	HY -DSL-R6-15W-3CCT
Size		
L1	Φ 150mm/ Φ 5.9"	Φ 185mm/ Φ 7.28"
L2	25mm/0.98"	25mm/0.98"

PHOTOMETRIC REPORT
4" LIGHT

LUMINOUS INTENSITY DISTRIBUTION DIAGRAM

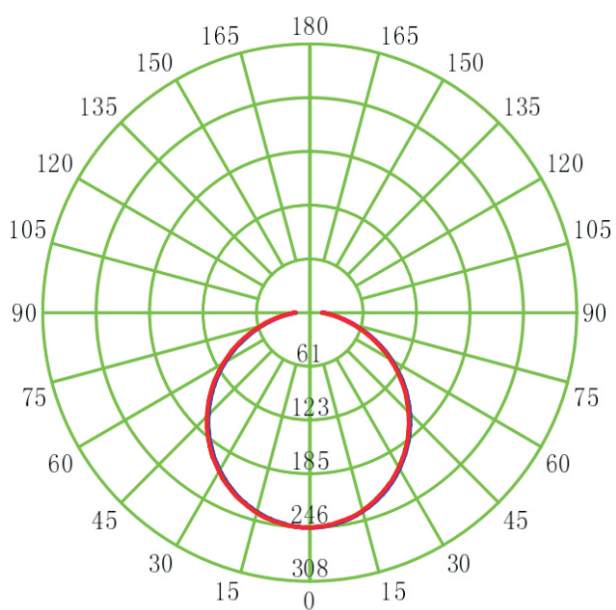

UNIT: cd

C0-C180

C90-C270

VERTICAL EQUILUMINOUS CURVE

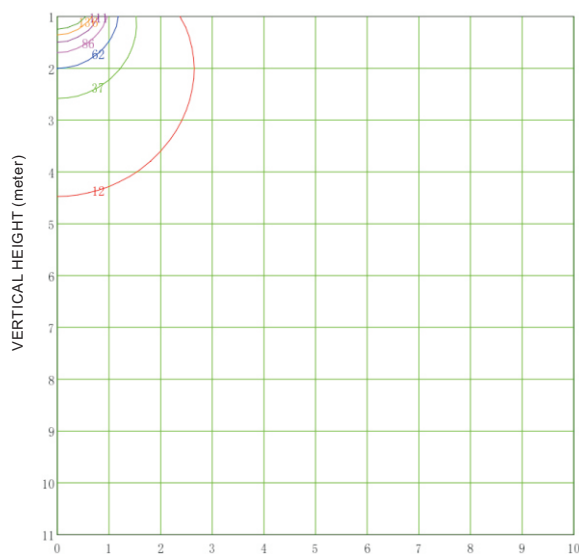

HORIZONTAL DISTANCE (meter)

 MINIMUM ALTITUDE 1.0 M
 MAXIMUM ALTITUDE 11.0 M
 MAXIMUM ILLUMINATION 246.7 lx

(5%): 12.3 lx	(15%): 37.0 lx
(25%): 61.7 lx	(35%): 86.3 lx
(45%): 111.0 lx	(55%): 135.7 lx
(65%): 160.3 lx	

**ORDERING GUIDE**

Package Information		
Model No.	HY -DSL-R4-10W-3CCT	HY -DSL-R6-15W-3CCT
Size	4"	6"
Qty/Pack	30PCS	30PCS
Package Size	490X190X335mm	595X190x405mm
	19.3"X7.5"X13.2"	23.4"X7.5"X15.9"
Package Weight	6.3kg/ 13.9lbs	8.7kg/19.2 lbs
Package CBM	0.031189	0.045785

ORDERING CODE DEFINITION

Company Code	Product	Size	Watt	3CCT
HY	DSL: LED DISK LIGHT	R4: 4" R6: 6"	10W 15W	3CCT Tunable 3000K /4000K/5000K

WARNING

Failure to install and wire fixture in accordance with the National Electrical Codes(NEC), all applicable Federal, State and Local electrical codes, as well as specific U.L. Safety standards for the intended working environment (location/application), may cause serious personal injury, death and or property damage. This product must be installed by a person familiar with the construction and operation of the product and the hazards involved.

For 120V 60Hz use only. Risk of fire and electrical shock, most dwellings built before 1985 have supply wires rated 60C. Consult a qualified electrician before installing. IF supply wires are located within 3 inches of the ballast, use wires rated at least 90°C.

The LED fixture is Triac dimming

- CAUTION:

TURN OFF POWER FROM THE MAIN CIRCUIT BEFORE INSTALLING FIXTURE. Make sure fixture is grounded per National Electrical Codes(ec). This fixture is suitable for damp locations.

- IMPORTANT NOTE:

The safe guards and instructions appearing in the page are not meant to cover all possible conditions and situations that may occur. It may be understood that common sense, cautions and care are factors which cannot be built into any product, The person(s) installing, operation and responsible for the light fixture, must execute. these factors.

INSTALLATION INSTRUCTION

1. Surface mount installation

STEPS

1. Turn off the power !
2. Remove the diffuser by turning the diffuser counterclockwise about 15 degrees
3. Electrical Connection: Connect the wires of the same color with the Terminal cap (the green line is the ground line, the black line is the fire line, the white line is the zero line)
4. Install the lamp body base on the junction box with mounting screw, But do not over tighten ! and ensure that the base is completely fitted to the ceiling
5. Install the removed diffuser back to the bottom of the lamp body in a clockwise direction
6. Turn on the power, make sure the light is on, and the installation is complete

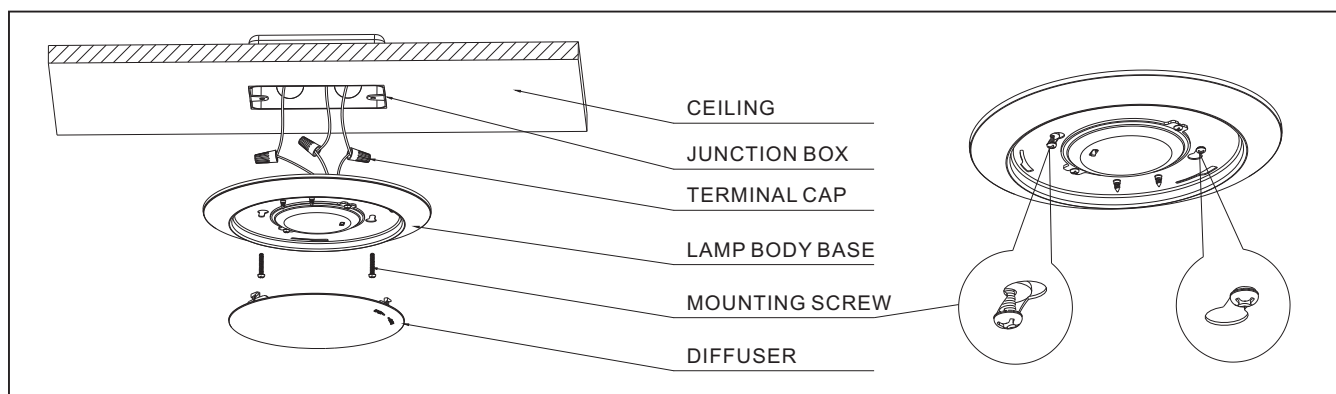

2. Embeded in installation

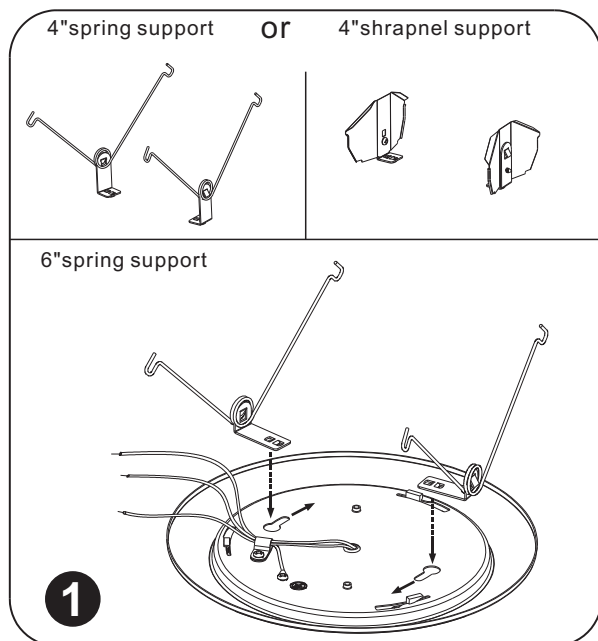

1. Align the hook of the spring support with the installation hole of the lamp and push it in as shown by the arrow.

4 "The lamps are divided into spring or shrapnel two installation methods

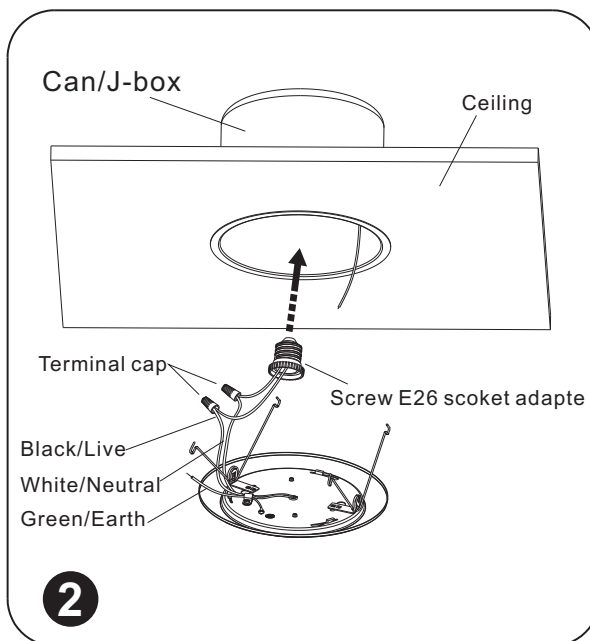

2. Connect the electric wire corresponding to the lamp and Screw E26 socket adapte (note: do not connect the ground wire at this time), and screw the Screw E26 socket adapte into the lamp holder of Can/J-box after completing the wiring.



INSTALLATION INSTRUCTION

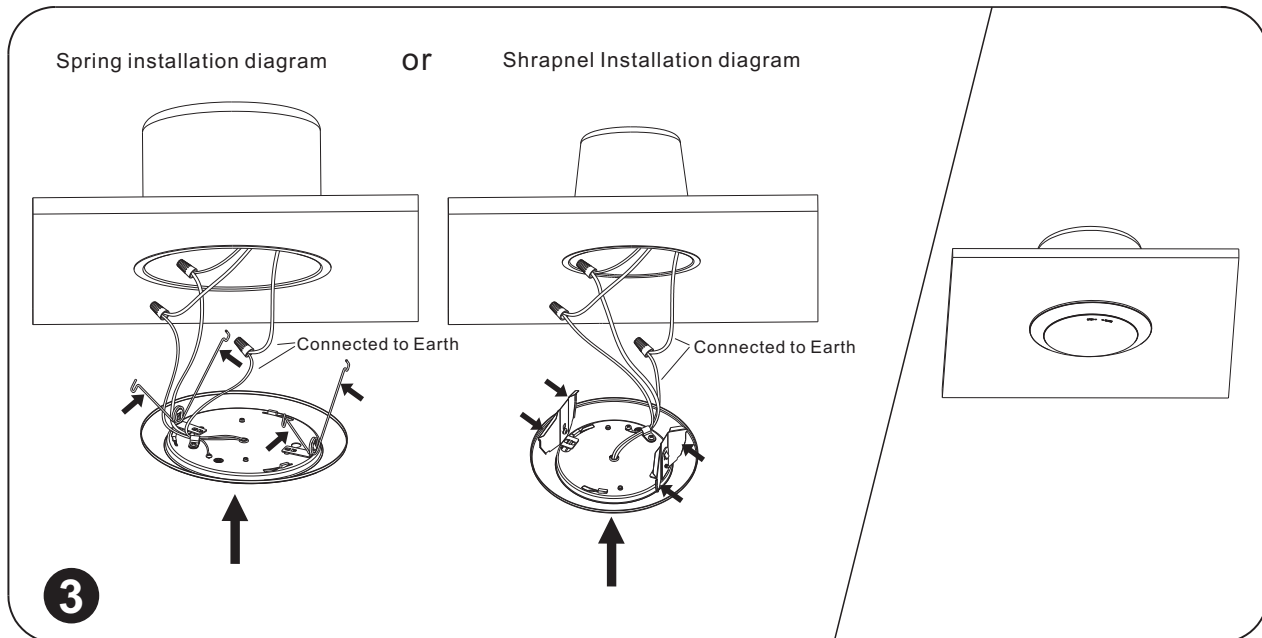

3. After connecting the lamp to the ground cable on the Can/J-box, Press the spring or shrapnel to align it with the Can/J-box and push the lamp into the Can/J-box. Finally, the power supply is switched on and the installation is completed.

OPERATING GUIDE

1 CCT Adjustable

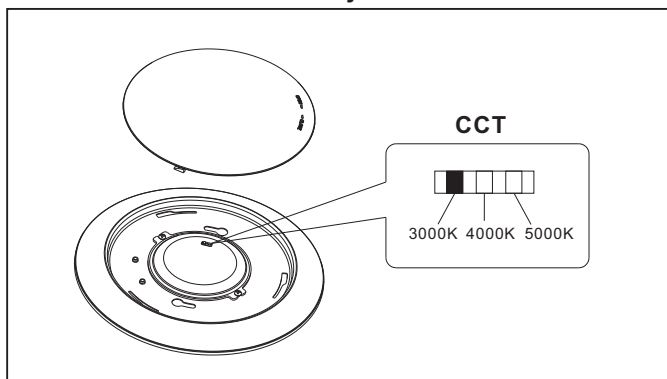

2 Wiring Guide

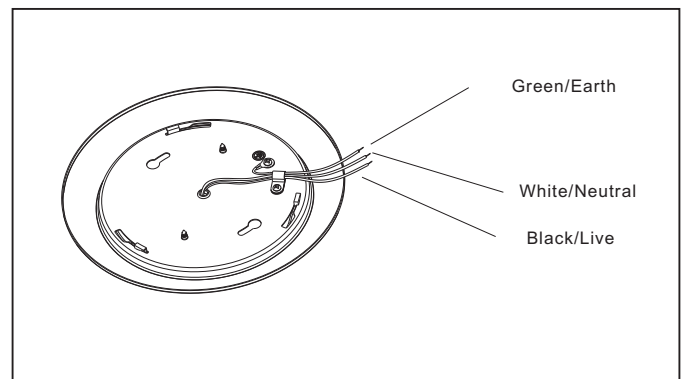

Accessories bag includes:

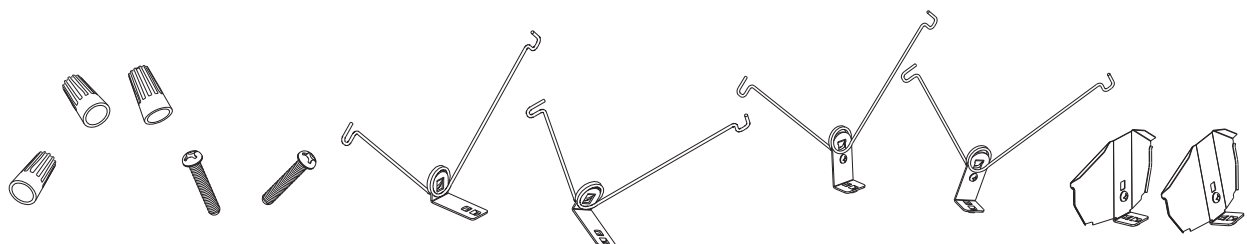

Zhejiang Hongyao Lighting Electrical Co., Ltd

No.209 Shennan Rd. Da Yang Jie Dao, Linhai City. Zhejiang China 317000 www.chongyao.com
Trading@chongyao.com Tel: +86 576-85381918 Fax: +86 576-85381913